

Product Overview

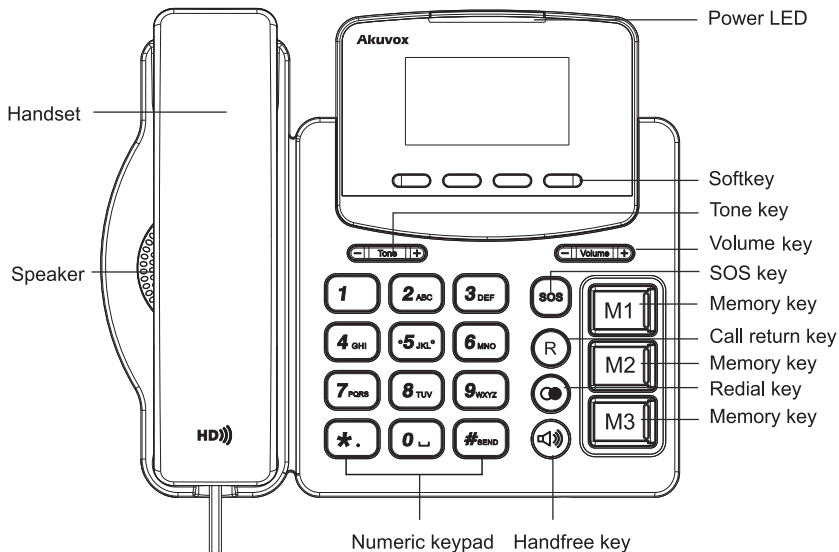

Status Information

Registered		Network disconnection	
Register failed		Ring off	
Registering		Headset mode	
Deactivated account		New voice message	
Forward		New text message	
Auto answer		Missed calls	
Do Not Disturb		Warning	

Akuvox

Unpacking

Please make sure the package contains the following items:



IP-Phone x 1



Stand x 1



Handset with cord x 1



Ethernet cable x 1



Quick guide x 1



Power Adapter x 1 (Optional)

Basic Setup

Mounting: Slide the short edges of the L-shaped stand (the prongs) into the phone's two rear slots (see below). Slide the prongs in until they are locked.

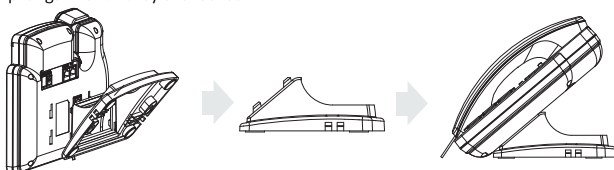

Connect the handset and optional headset as shown below:

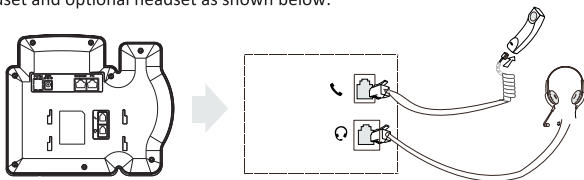

Connect Network Cable and Power

You can either connect the IP-Phone to the power adapter directly or a PoE (Power over Ethernet) compliant switch or hub. The IP-phone can also share the network connection with other network devices by using PC port. Connection is shown below:

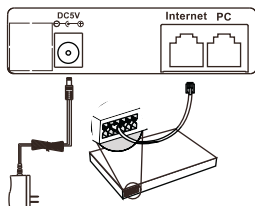

Note:

If Power over Ethernet is being used, don't plug in the AC adapter.

Configuration

1. After setting up the network and power, connect IP phone to your computer, then press  menu softkey then select Status then check the IP address in the main menu. *(If you are using DHCP to obtain IP address)*
2. Launch web browser and type in the IP address to access web interface. Login with username and passwords(admin by default).
3. Register the device using your SIP account. *(Please refer to user manual for more information)*

Operation



Make a call

- Pick up the handset, enter a phone number then press the  softkey or # key to make a call.
- Press RF key to initiate a call in the phone.

Redial

Press the Redial key  , select a dialed number then press the Redial key  again.

Receive a call

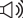
- **During a call:** Press  softkey to accept a second call or press  softkey to reject it.
- **Idle state:** 1. Pick up the handset 2. Press  softkey
3. Press Handfree key 

Mute a call

Press the  softkey; To resume the conversation, press the  softkey again.

Hold a call

Press  softkey to hold the current conversation.

Special features

1. **SOS key:** Dedicated button for any emergency situations, it can be configured as Emergency call feature to call out pre-configured 3 numbers in a loop.

To configure SOS key:

- Press and hold SOS key for several seconds to configure the numbers.
- Go to phone webpage→Phone→Emergency Call→Emergency Call.

2. Memory Key: To help users contact with their important relatives easily and quickly, three distinct buttons can be configured to save phone number. When there is a need, simply press the button to reach their families.

To configure Memory keys:

- Press and hold Memory key for several seconds to configure the number.
- Go to phone webpage→Phone→Key/Display→Function key.

3. RF key: The RF key is the small size of pendant on your hand, which enabled multiple features gives user remote control ability to control the phone.

To configure RF key:

- Go to phone webpage→Phone→Emergency Call→RF key.

FCC Caution

Any Changes or modifications not expressly approved by the party responsible for compliance could void the user's authority to operate the equipment.

This device complies with part 15 of the FCC Rules. Operation is subject to the following two conditions:

- (1) This device may not cause harmful interference, and
- (2) this device must accept any interference received, including interference that may cause undesired operation.

This equipment complies with FCC radiation exposure limits set forth for an uncontrolled environment .

This transmitter must not be co-located or operating in conjunction with any other antenna or transmitter.

Note: This equipment has been tested and found to comply with the limits for a Class B digital device, pursuant to part 15 of the FCC Rules. These limits are designed to provide reasonable protection against harmful interference in a residential installation. This equipment generates, uses and can radiate radio frequency energy and, if not installed and used in accordance with the instructions, may cause harmful interference to radio communications. However, there is no guarantee that interference will not occur in a particular installation. If this equipment does cause harmful interference to radio or television reception, which can be determined by turning the equipment off and on, the user is encouraged to try to correct the interference by one or more of the following measures:

- Reorient or relocate the receiving antenna.
- Increase the separation between the equipment and receiver.
- Connect the equipment into an outlet on a circuit different from that to which the receiver is connected.
- Consult the dealer or an experienced radio/TV technician for help.

Notice Information



Information contained in this document is believed to be accurate and reliable at the time of printing. This document is subject to change without notice, any update to this document can be viewed on Akuvox's website: <http://www.akuvox.com> © Copyright 2018 Akuvox Ltd. All rights reserved.

AKUVOX (XIAMEN) NETWORKS CO., LTD.

ADD: 10/F, NO.56 GUANRI ROAD, SOFTWARE PARK II, XIAMEN 361009, CHINA
www.akuvox.com



YS1500002